



## CITY OF LIBBY

952 E. SPRUCE | POST OFFICE BOX 1428

| PHONE 406-293-2731 | FAX 406-293-4090 | WEBSITE: [www.cityoflibby.com](http://www.cityoflibby.com)

### SPECIAL COUNCIL MEETING # 1576

JUNE 24, 2020 @ 6:15PM

COUNCIL CHAMBERS – CITY HALL

#### **CALL TO ORDER:**

- Pledge of Allegiance
- Roll Call
- Welcome

**NEW BUSINESS:** Each new agenda item will be introduced by the Mayor (or assigned liaison) with a description of the item and explanation for the recommended action. Following council discussion on each item will be an opportunity for public comment (prior to any action taken). Public comment is limited to agenda item being discussed is limited to 3 minutes.

1. Approve mitigation construction on Flower Creek Dam spoils pile.

#### **GENERAL COMMENTS FROM COUNCIL:**

#### **ADJOURNMENT:**

The manner of Addressing Council:

Each person, not a Council member shall address the Council, at the time designated in the agenda or as directed by the Council, by stepping to the podium or microphone, giving that person's name and address in an audible tone of voice for the record, unless further time is granted by the Council, shall limit the address to the Council to three minutes.

All remarks shall be addressed to the Council as a body and not to any member of the Council or Staff. No person all remarks shall be addressed to the Council as a body and not to any member of the Council or Staff.

No person, other than the Council and the person having the floor, shall be permitted to enter any discussion either directly or through a member of the Council, without the permission of the Presiding Office Any person making personal, impertinent or slanderous remarks or who shall become boisterous or disruptive during the council meeting shall be forthwith barred from further presentation to the council by the presiding officer unless permission to continue by granted by a majority vote of the council.

#### ATTENTION:

To access this meeting electronically with ZOOM,  
Dial: 253-215-8782  
Meeting ID: 4042719951  
Password: 151041

Posted: 6/22/2021



PROPOSED GRADING PLAN  
 Limits of Grading - - - -  
 Existing Site Fence - - - -

1278' ±  
 4



**SUMMIT GROUP**

210 South Wallace  
Bozeman, MT 59715  
(406) 585-7770  
Fax (406) 585-7446

P.O. Box 1810  
Great Falls, MT 59403  
(406) 452-9970  
Fax (406) 771-0526

1600 North Ave. West, Suite 105  
Missoula, Montana 59801  
(406) 728-6300  
Fax (406) 728-6319

JOB \_\_\_\_\_  
SHEET NO. 1 OF \_\_\_\_\_  
CALCULATED BY \_\_\_\_\_ DATE 26-5-21  
CHECKED BY \_\_\_\_\_ DATE \_\_\_\_\_  
SCALE \_\_\_\_\_

EXISTING STOCK PILE

STOCK PILE MATERIAL SANDY SILTY  
Gravel (FLUVIAL) & ANGULAR rock.

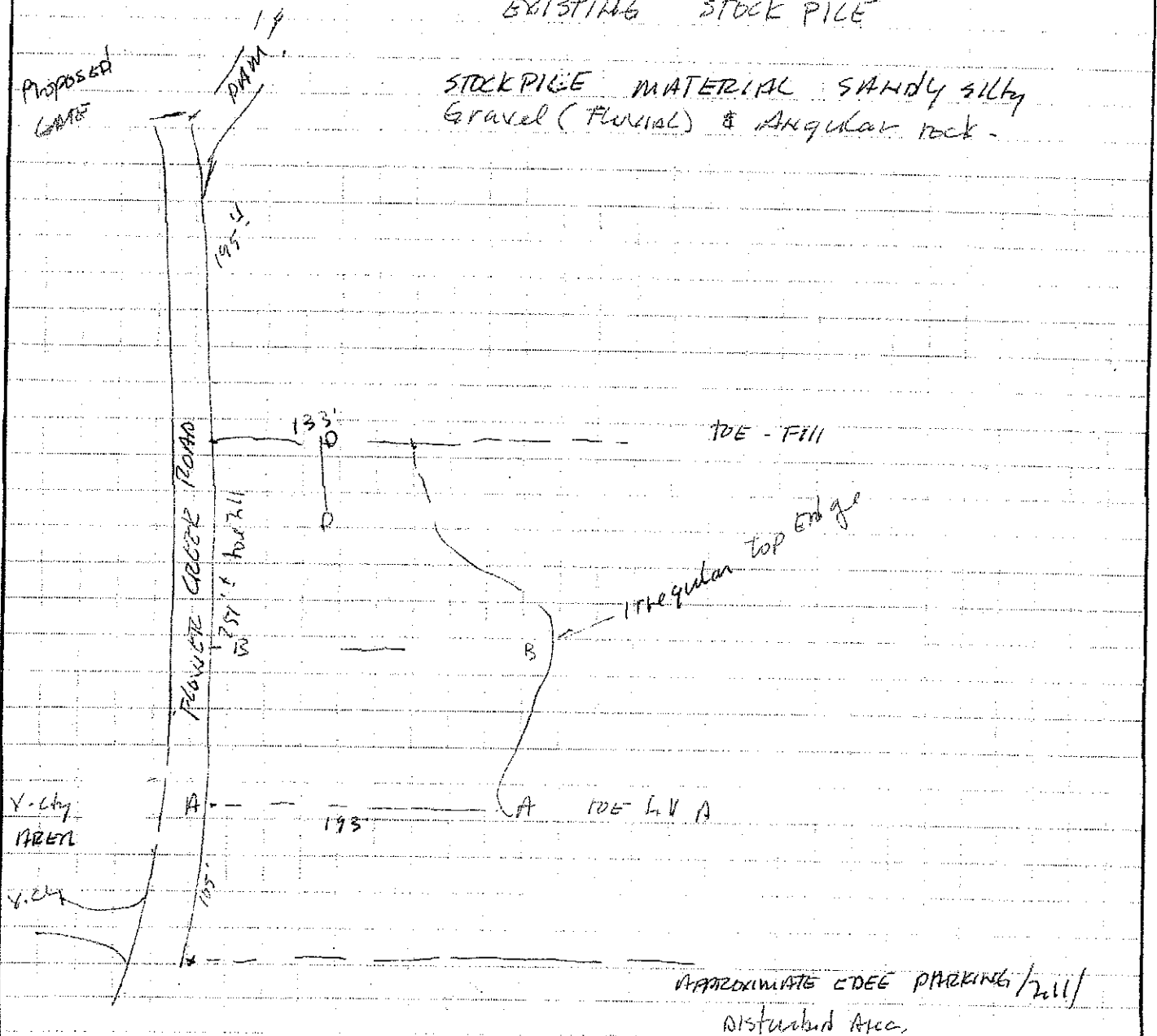

1" = 100'  $\rightarrow$  Approx.

# SUMMIT GROUP

210 South Wallace  
Bozeman, MT 59715  
(406) 585-7770  
Fax (406) 585-7446

P.O. Box 1810  
Great Falls, MT 59403  
(406) 452-9970  
Fax (406) 771-0626

1600 North Ave. West, Suite 105  
Missoula, Montana 59801  
(406) 728-6300  
Fax (406) 728-6319

JOB \_\_\_\_\_  
SHEET NO. 2 OF \_\_\_\_\_  
CALCULATED BY \_\_\_\_\_ DATE \_\_\_\_\_  
CHECKED BY \_\_\_\_\_ DATE \_\_\_\_\_  
SCALE \_\_\_\_\_

SECTION A-A  $1" = 50' H$   
 $1" = 5' V$

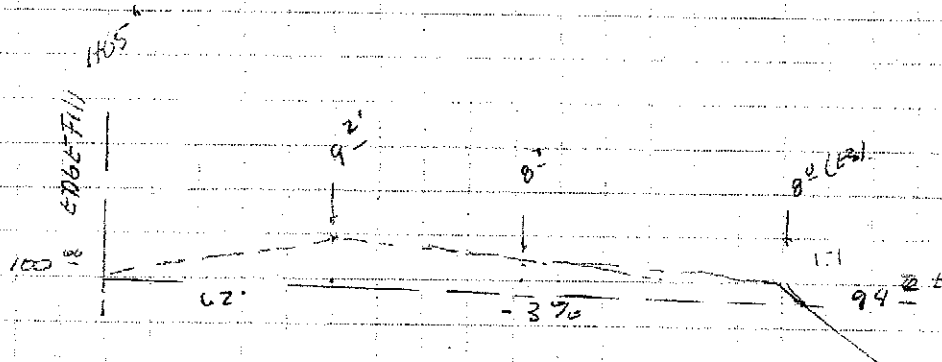

END AREA  $\left( \frac{0 + 9^2 + 8^2 + 8^2}{3} \right) \times 193 = 1273 \text{ #}$

SECTION B-B  $1" = 50' H$   
 $1" = 50' V$

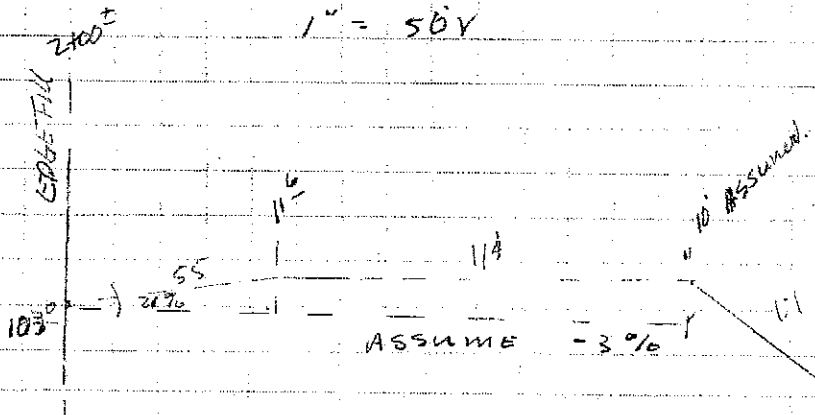

END AREA  $\left( \frac{0 + 11^2 + 10^2}{3} \right) \times 169 = 1210 \text{ #}$

# SUMMIT GROUP

210 South Wallace  
Bozeman, MT 59715  
(406) 585-7770  
Fax (406) 585-7446

P.O. Box 1810  
Great Falls, MT 59403  
(406) 452-9970  
Fax (406) 771-0626

1600 North Ave. West, Suite 105  
Missoula, Montana 59801  
(406) 728-6300  
Fax (406) 728-6319

JOB \_\_\_\_\_

SHEET NO. 3 OF \_\_\_\_\_

CALCULATED BY \_\_\_\_\_ DATE \_\_\_\_\_

CHECKED BY \_\_\_\_\_ DATE \_\_\_\_\_

SCALE \_\_\_\_\_

SECTION D

1" = 50' H

1" = 50' V

TO BE FILL

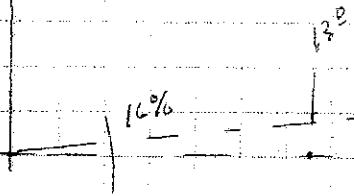

# SUMMIT GROUP

210 South Wallace  
Bozeman, MT 59715  
(406) 585-7770  
Fax (406) 585-7446

P.O. Box 1810  
Great Falls, MT 59403  
(406) 452-9970  
Fax (406) 771-0626

1600 North Ave. West, Suite 105  
Missoula, Montana 59801  
(406) 728-6300  
Fax (406) 728-6319

JOB \_\_\_\_\_

SHEET NO. 4 OF \_\_\_\_\_

CALCULATED BY \_\_\_\_\_ DATE \_\_\_\_\_

CHECKED BY \_\_\_\_\_ DATE \_\_\_\_\_

SCALE \_\_\_\_\_

Volume Calculation -

$$C = 0$$

$$\left( \frac{A + B + C}{3} \right) \times 280 = \text{ft}^3$$

$$\left( \frac{1273 + 1217 + 0}{3} \right) \times 280 = 232,400 \text{ ft}^3 = 8,607 \text{ CYDS}$$

# SUMMIT GROUP

210 South Wallace  
Bozeman, MT 59715  
(406) 585-7770  
Fax (406) 585-7446

P.O. Box 1810  
Great Falls, MT 59403  
(406) 452-9970  
Fax (406) 771-0626

1600 North Ave. West, Suite 105  
Missoula, Montana 59801  
(406) 728-6300  
Fax (406) 728-6319

JOB \_\_\_\_\_  
SHEET NO. 5 OF \_\_\_\_\_  
CALCULATED BY \_\_\_\_\_ DATE \_\_\_\_\_  
CHECKED BY \_\_\_\_\_ DATE \_\_\_\_\_  
SCALE \_\_\_\_\_

SPREAD:

TOTAL Length -

$$105' + 251 + 195' = 531'$$

width -

$$193 + 100 = 293/2 = 146.5$$

$$\text{AREA} = 77,792 \text{ sq. ft.}$$

$$232,400 / 77,792 = 2.98 \text{ thick.}$$

Slope from creek to top  $\approx$  6' from 2 points  
measured.



**SUMMIT GROUP**

210 South Wallace  
Bozeman, MT 59715  
(406) 585-7770  
Fax (406) 585-7446

P.O. Box 1810  
Great Falls, MT 59403  
(406) 452-8970  
Fax (406) 771-0626

1600 North Ave. West, Suite 105  
Missoula, Montana 59801  
(406) 728-6300  
Fax (406) 728-6319

JOB \_\_\_\_\_

SHEET NO. \_\_\_\_\_ OF \_\_\_\_\_

CALCULATED BY \_\_\_\_\_ DATE \_\_\_\_\_

CHECKED BY \_\_\_\_\_ DATE \_\_\_\_\_

SCALE \_\_\_\_\_

